



The CONTINENTAL Apartments

A RENTAL COMMUNITY



Offering studios, one and two bedroom apartments with screened in balconies, eat-in kitchens and walk in closets.

Originally built as a condominium, the Continental offers the spacious floor plans that usually are not found in rental communities including en suite master bathrooms, walk in closets and eat-in kitchens.

Located conveniently in the center of the city of Lauderhill, the Continental is close to all major highways.

Enjoy the large swimming pool on the property as well as the smaller kids pool.

Laundry facilities located in every building are operated by a card system for the added convenience to our residents.

All residents receive complimentary maintenance, pest control and trash collection.

FOR MORE INFORMATION
WEB TOURS AND PICTURES
VISIT OUR WEB SITE AT
WWW.JENCOPROPERTIES.COM

PHONE. 954-739.7373
FAX. 954-739.7141



CONTINENTAL Apartments

1861 NW 46TH AVENUE
LAUDERHILL, FL 33313

The CONTINENTAL Apartments

A RENTAL COMMUNITY



1861 NW 46TH AVENUE
LAUDERHILL, FL 33313

PHONE. 954-739.7373
FAX. 954-739.7141

FOR MORE INFORMATION
VISITS US AT
WWW.JENCOPROPERTIES.COM

1 BEDROOM CORNER UNIT
780 SQ. FOOT

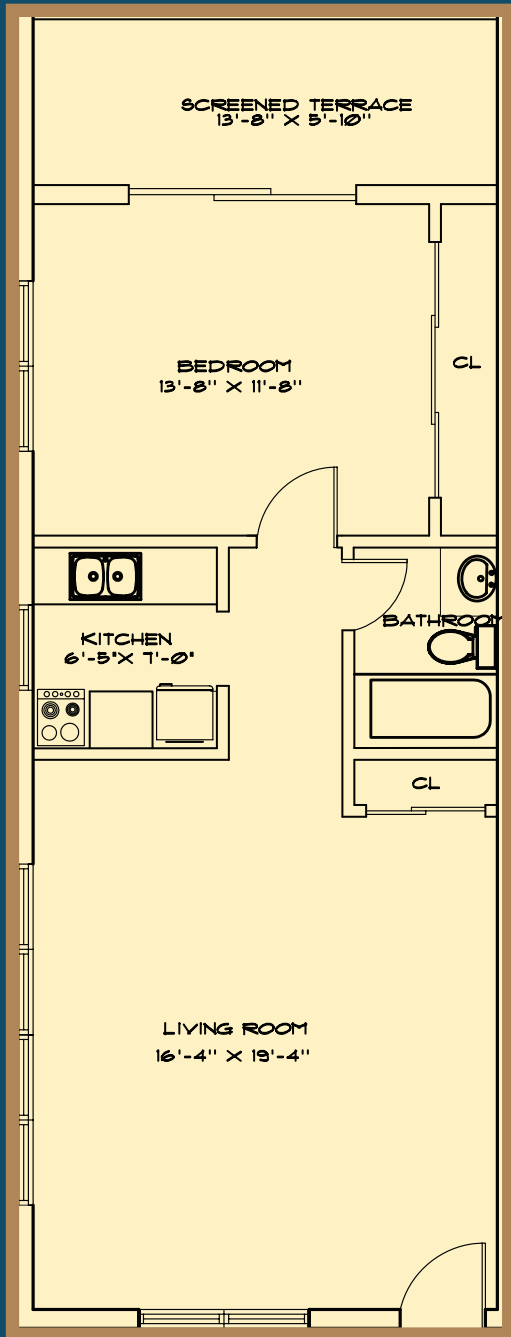

PHONE. 954-739.7373
FAX. 954-739.7141

1 BEDROOM UNIT
780 SQ. FOOT

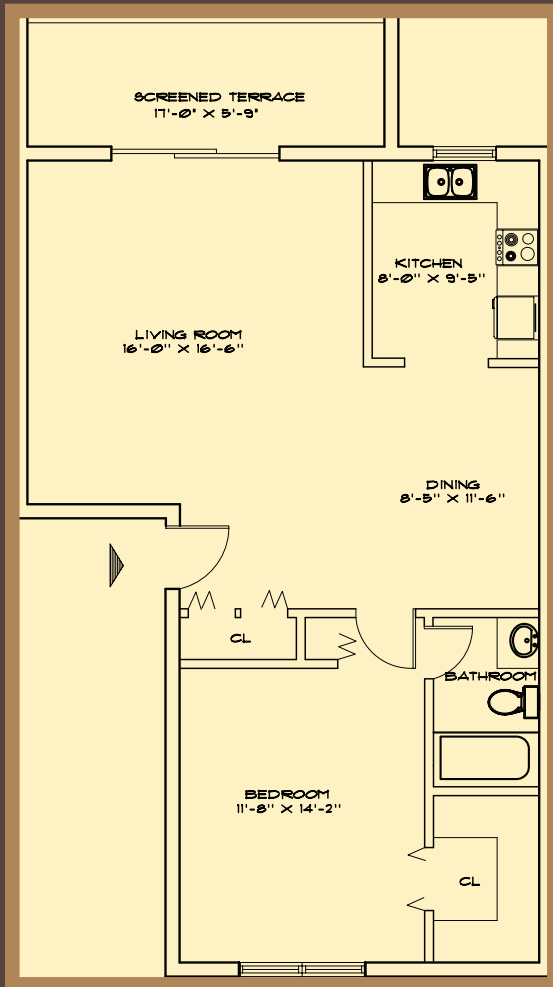

DOWNLOAD AN APPLICATION AT
WWW.JENCOPROPERTIES.COM

2 BEDROOM UNIT
1010 SQ. FOOT

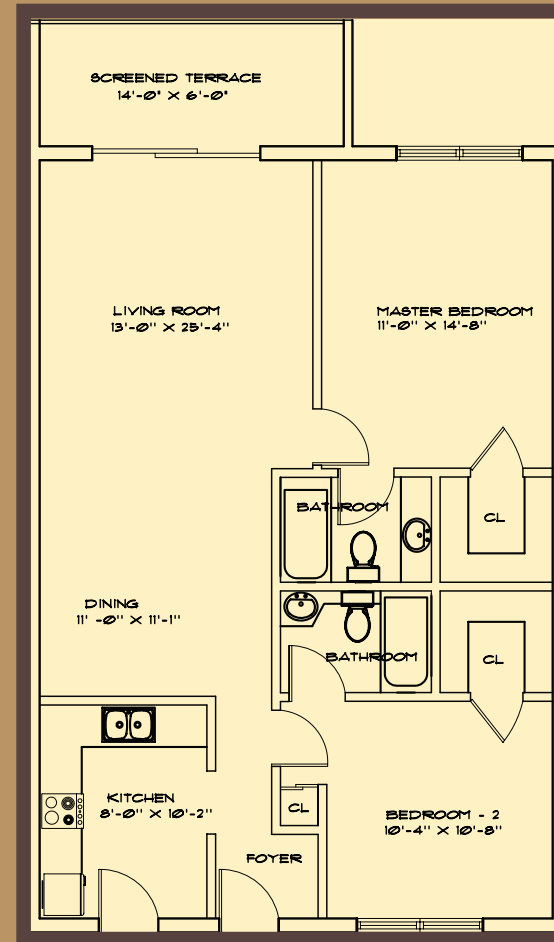

FOR MORE INFORMATION
WEB TOURS AND PICTURES
VISIT OUR WEB SITE AT
WWW.JENCOPROPERTIES.COM

The
CONTINENTAL
Apartments
A RENTAL COMMUNITY



1861 NW 46TH AVENUE
LAUDERHILL, FL 33313